

Psychiatry Clerkship Clinical Site Descriptions 2024-25

1) Adult Inpatient @ Augustus Hawkins

1720 East 120th St. Los Angeles, CA 90059



Nature of clinical service: Students are based on an LA County adult inpatient psychiatric ward at Augustus Hawkins Mental Health Center at MLK Hospital in Willowbrook.

Unique aspects of this site: Working closely with a multidisciplinary team (which includes Psychiatry attendings, residents, occupational therapists, recreational therapists, nurses, pharmacists, and pharmacy students), students will treat patients using a range of treatment modalities. Will also be exposed to the legal aspects of involuntary hospitalization.

Most common diagnoses seen: Patient diagnoses include bipolar disorder, schizophrenia, major depression, and schizoaffective disorder, among others.

Ideal rotation site for: Students considering psychiatry as a career choice desiring exposure to acute patient presentations and symptomatology.

2) Adolescent Inpatient @ Augustus Hawkins

1720 East 120th St. Los Angeles, CA 90059



Nature of clinical service: Evaluation and treatment of adolescents (ages 12 -17) with acute onset of psychiatric disorders. Students participate in the assessment, medication management and elaboration of discharge plans as part of a multidisciplinary treatment team. Students attend lectures and other activities sponsored by the Division of Child and Adolescent Psychiatry.

Unique aspects of this site: Wide exposure to different psychiatric disorders affecting the adolescent population. Opportunity to work with patients, their families, and other disciplines such as Department of Children Services, School, and Probation Department.

Most common diagnoses seen: Depressive Disorders, Bipolar Disorders, Psychotic Disorders, Intellectual Disabilities and Autism Spectrum Disorder.

Ideal rotation site for: Students that are interested in a spectrum of mental health modalities and in how adolescents can be affected and treated.

3) Adult Consultation-Liaison Service @ LA General Medical Center
2051 Marengo St, Los Angeles, CA 90033



Nature of clinical service: Students are based on the Adult Psychiatric C&L Service at the LA General Medical Center seeing adult patients throughout the 600-bed hospital, including a 24-bed, locked ward for medical patients with psychiatric co-morbidity. Under close supervision by staff and residents, students will provide routine and emergency consultation and follow-up visits for patients hospitalized throughout the medical and surgical inpatient wards.

Unique aspects of this site: Public-funded County hospital and tertiary care center offering full medical, surgical, emergency, and intensive care services for patients of a variety of socioeconomic and ethnic backgrounds. Students become part of the Psychiatry consultation liaison team consisting of PGY-2, PGY-4 residents, pharmacy students, psychiatric social workers and attending staff.

Most common diagnoses seen: Substance abuse, bipolar disease, major depression, schizophrenia, post-traumatic stress disorder, dementia and a variety of comorbid conditions.

Ideal rotation site for: Students interested in psychosomatic medicine and those interested in gaining experience with patients with severe mental illness, multiple medical comorbidities and other major social psychiatric problems such as substance abuse, homelessness and AIDS.

4) Adult Consultation-Liaison Service @ Keck Hospital
1500 San Pablo St, Los Angeles, CA 90033



Nature of clinical service: Psychiatric consultation on medical high acuity patients at Keck and Norris Hospitals. Transplant, oncology, neurology, and critical care patients make most consultations here. Liaison work with medical teams is highly emphasized.

Unique aspects of this site: Volume of exposure to transplant, post-surgical, and critical care patients.

Most common diagnoses seen: Delirium, dementia, depressive, and anxiety disorders. Less commonly seen are psychotic and bipolar disorders.

Ideal rotation site for: Students who are interested in hospital-based specialties, surgical specialties, and primary care, as well as students who are specifically interested in consultation-liaison psychiatry.

5) Child Crisis Service @ LA General Medical Center

2051 Marengo St, Los Angeles, CA 90033



Nature of clinical service: Psychiatric consultation on high acuity psychiatric and medically ill pediatric patients. Liaison with ER and inpatient pediatric teams is emphasized.

Unique aspects of this site: High volume of highly acute psychiatrically ill pediatric patients.

Most common diagnoses seen: Depression, anxiety, PTSD, abuse and neglect, ADHD, disruptive behavior disorders, autism spectrum disorders, delirium, substance abuse or intoxication.

Ideal rotation site for: Students interested in medical pediatrics, emergency medicine or child psychiatry.

6) Psychiatry Emergency Service @ LA General Medical Center

2051 Marengo St, Los Angeles, CA 90033



Nature of clinical service: Students are based in the LA County Psychiatric Emergency Room, a 20-bed locked facility for patients presenting acutely from the community.

Unique aspects of this site: Students experience how individuals with severe mental illness present acutely from the community, mostly on involuntary psychiatric holds. There is high acuity in this population. Additionally, there is a high turnover of patients with new patients to be seen each day.

Most common diagnoses seen: Patient's present with a variety of psychiatric illnesses including mood disorders, psychotic disorders, and cognitive disorders. Often there is co-morbid substance abuse that influences the severity of the presentation.

Ideal rotation site for: Students considering psychiatry as a career choice desiring exposure to acute patient presentations and symptomatology. Students considering Emergency Medicine, wanting exposure to psychiatric emergencies.

7) Aurora Las Encinas Hospital

2900 E Del Mar Blvd, Pasadena, CA 91107



Nature of clinical service: Rotation through various clinical services including Acute Inpatient Psychiatric Units, Partial Hospitalization Program, Chemical Dependency Residential Program, Private Practice outpatient office.

Unique aspects of this site: During the rotation, each student

is supervised by private practice psychiatrists, one of which is board certified in Addiction Psychiatry. This allows opportunities to learn not only from different practice settings, but also with a variety of different psychiatric practice styles.

Most common diagnoses seen: A wide variety of diagnoses are seen and treated given the various clinical settings used. Common diagnoses include Unipolar Depression, Bipolar Disorder, Schizophrenia, Substance Abuse and Dual Diagnosis.

Ideal rotation site for: Students who value a variety and high volume of psychiatric services provided by private practice psychiatrists. This site is ideal for those pursuing primary care or psychiatry careers who would like to develop a solid foundation in their specialty on which to build.

8) **Adult Inpatient Service @ Kaweah Delta**

1100 S Akers St, Visalia, CA 93277



Nature of clinical service: This will include seeing patients on the inpatient psychiatric units at Kaweah Delta's standalone Mental Health Hospital. Students will engage in daily treatment planning with the multidisciplinary team and work closely with residents of the Kaweah Delta residency program.

Unique aspects of this site: This is a unique experience of how psychiatry is practiced outside of Los Angeles in Visalia (population 140,000+) near Sequoia National Park.

Most common diagnoses seen: major depression, schizophrenia, chemical dependency, bipolar disorder.

Ideal rotation site for: Those choosing psychiatry as a profession as well as those who know they do not want to be psychiatrists. Anyone who may want to practice in rural settings where medical services are limited would benefit from rotating here.

9) **Cottage Hospital**

400 W Pueblo Street, Santa Barbara, CA 93105



Nature of clinical service: Cottage offers a hospital-based psychiatry services experience within a 325-bed general medical surgical community hospital. Students work on a 20-bed voluntary inpatient psychiatry and chemical dependency unit; a 12-bed Emergency Psychiatry service; Consult Liaison psychiatry to all medical and surgical services, including some pediatric patients; and a 24-bed community based residential addictions program with a 3-to-4-week length of stay.

Unique aspects of this site: Clinical experience in many different psychiatry settings; a patient

population that includes a full range of psychiatry diagnoses and addiction problems; opportunity to work directly with attending psychiatrists (not a hospital that has a psychiatry residency); multidisciplinary team experience.

Most common diagnoses seen: Full range of psychotic disorders, bipolar illness, depression and anxiety, personality disorders, alcohol and opiate and other addiction disorders, delirium and dementia, family crises and more.

Ideal rotation site for: A student who would like to experience a broad range of patients and treatment settings, work directly with attending psychiatrists and multidisciplinary teams, and see what varied opportunities a career in psychiatry can offer.

10) Children's Hospital Los Angeles

4650 Sunset Blvd, Los Angeles, CA 90027



Nature of clinical service: Psychiatric consultation on medical high acuity patients at Children's Hospital Los Angeles (CHLA). Transplant patients, oncology patients, neurology patients, rheumatology patients, and critical care patients make the majority of consultations here. A number of patients are seen on the pediatric physical rehabilitation unit, and occasionally in the emergency room, at CHLA as well. Liaison work with medical teams is highly emphasized.

Unique aspects of this site: As part of the CHLA Pediatric Psychiatric Consultation-Liaison Service, the student will be involved in the psychiatric assessment and management of complex patients with a broad range of psychiatric and medical disorders under the close supervision of the attending psychiatrists and child-adolescent psychiatry fellow. The student will gain an appreciation of the complexities of working as a consultant in the medical environment.

Most common diagnoses seen: These include delirium, depressive disorders, anxiety disorders, and somatoform disorders. Eating disorders and psychotic disorders are also seen.

Ideal rotation site for: Students who are interested in hospital-based specialties, surgical specialties, and primary care, as well as students who are specifically interested in psychiatry and working with children.

11) Adult Outpatient Service @ LA General Medical Center

2051 Marengo St, Los Angeles, CA 90033



Nature of clinical service: Experience a different side of psychiatry that is more routine with a regular flow of patients from East LA. Students will work closely with residents in the clinic to provide medication management and occasionally therapy services to Medi-Cal patients.

Unique aspects of this site: Provides students with a realistic

understanding of what outpatient psychiatric services truly entails rather than what is seen on TV.

Most common diagnoses seen: Depression, Anxiety, PTSD, Bipolar Disorder, Psychotic Disorders, Personality Disorders, Substance Use Disorders

Ideal rotation site for: Students interested in longitudinal health care will appreciate working with lower acuity patients at this site.

12) Child and Adolescent Outpatient Service @ LA General Medical Center
2051 Marengo St, Los Angeles, CA 90033



Nature of clinical service: Students will work closely with both fellows and attendings in this clinic to provide mental health services to youths in Los Angeles. This rotation will challenge students to become creative in their approaches when interviewing patients and their families.

Unique aspects of this site: This will provide students with a glimpse into the multisystem approach to pediatric patient care, i.e., working with parents, schools, DCFS, guardians, Regional Center, etc.

Most common diagnoses seen: Depression, Anxiety, PTSD, abuse and neglect, ADHD, disruptive behavior disorders, autism spectrum disorders.

Ideal rotation site for: Students interested in longitudinal health care with pediatric patients who also enjoy collaborating with parents will enjoy working with trainees on this service.

13) Ventura County Medical Center
300 Hillmont, Ventura, CA 93003

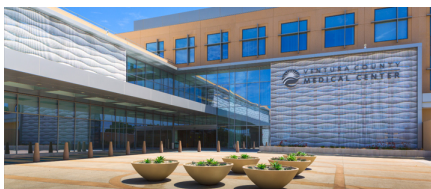

Nature of clinical service: Students will have the opportunity to be actively involved in evaluating and treating diverse patients with active psychotic, mood, and personality disorders. There are a significant number of patients who also have co-occurring issues with addiction.

Unique aspects of this site: At VCMC, students will rotate on the Inpatient Psychiatric Unit, a locked adult acute unit, the Crisis Stabilization Unit, an acute emergency psychiatry service, and the Consultation/Liaison Service, providing psychiatric care for medical and surgical inpatients. There is also an opportunity to participate in mental health Court Hearings for patients who are on legal holds, those patients who are being held involuntary due to acute danger to themselves, or to others or who are considered gravely disabled and unable to care for their basic needs for food, clothing and shelter.

Most common diagnoses seen: Depression, Anxiety, Psychotic Disorders, Personality Disorders, Substance Use Disorders

Ideal rotation site for: Students interested in acute stabilization of mental illness.